



# ADVENTURE

OUTDOOR RECREATION AND ADVENTURE PROGRAMS

★ ★ ★ APRIL ★ ★ ★



ICE CLIMBING ★ SKI/SNOWBOARD PIKES PEAK ★ SNOWSHOEING





# OUTDOOR ADVENTURE ACTIVITIES

*Book your winter adventures early to ensure you get out into the mountains with us this season!*

## SKI/SNOWBOARD AND ALPINE CLIMBING ON PIKES PEAK

**Ski/Board Days:** April 6, 7, 20, 21 | 6am–4pm

**Climbing Days:** email [usafarrafting@gmail.com](mailto:usafarrafting@gmail.com)

After much work, USAFA OAP is one of only two permit holders for Pikes Peak Alpine Climbs! Join our AMGA/IFMGA certified guides as we traverse thrilling steeps in Glen Cove. Learn to ski mountaineer and learn to apply avalanche safety principles to real avalanche terrain in spring skiing conditions. Our guides can also teach you how to climb and protect climbs on snow, ice and mixed terrain on the mountain. Come experience our home 14er like never before and learn how to move in the alpine. Includes any rental skis/board, avy gear, transportation, climbing equipment needed, and your local USAFA expert guide. Guide gratuity not included in price.

*Must be an advanced skier/riders.*

**\$139/person | R4R \$25/person.**

## INTERMEDIATE/ADVANCED ICE CLIMBING

**April 13 | 7–5pm.** Whether you have climbed before or have taken one of our beginner classes and are ready for something a little more advanced, this trip is for you! We will take you to our intermediate/advanced site and go over vertical ice, ice anchors, and anything else you are interested in learning. Refer to our ice climbing brochure or visit our website at [usafasupport.com/outdoor-recreation](http://usafasupport.com/outdoor-recreation) for more information.

To schedule a custom date email [usafarrafting@gmail.com](mailto:usafarrafting@gmail.com). Includes transportation, equipment, and guide. Two-person min, six-person max.

**\$150/person | R4R \$50/person.**

## DAYTIME SNOWSHOE

**April 14 | 9am–3pm.** Have cabin fever? Whether you're donning snowshoes for the first time or you're a pro, join us on this winter adventure in the beautiful kingdom of Farish! Warm refreshments provided for the journey. Dress in layers, because you will warm up quickly, wear sturdy waterproof boots and a jacket that covers your bum. Route is usually around three miles long depending on conditions and abilities. Includes transportation, snowshoes and guide. **\$39/person | SAPI, DAP \$9/person.**

## ADULT CPR CLASS

**April 20 | 8am-3pm.** Get your American Red Cross Adult/Child CPR, AED, and First Aid Certification with Certified Red Cross



Instructors. We teach Adult/Child CPR, AED and First Aid, rescue breathing, procedures for choking victims and more First Aid training. Our goal is to teach you the skills so that in the event of an emergency you will have the skills and confidence to assist someone in need. There is a 30-minute lunch break. Certification is good for two years. Five-person min, 10-person max. **Must be 18+, this is not a babysitter course.** **\$75/person.**

## AMERICAN RED CROSS ADULT/CHILD CPR, AED & FIRST AID RECERTIFICATION

Recertify your American Red Cross Adult/Child CPR, AED, and First Aid. This is a hybrid recertification course that includes a three-hour online training and a two-hour in-person skills test. Online training link will be sent to you one week prior to the scheduled skills test and must be completed before attending the skills class. Registration will close one week prior to the scheduled skills test. You must be able to provide proof of previous certification and not exceed expiration of certification by more than 30 days. **Must be 18+.** Contact ODR for course information at 719-333-4475. **\$50/person.**

## CREVASSE RESCUE COURSE

Training for a mountaineering/alpine objective like Mt. Rainier or Denali? Glacier travel is a must have skillset to move up and beyond the bigger peaks in North America, and is one of the most important skills to understand what to do if you or your partner falls in a crevasse. Learn best practices for rescuing your teammates from falling into the mountain from seasoned IFMGA

Mountain Guides right here on our home 14er, Pikes Peak! Email [usafarrafting@gmail.com](mailto:usafarrafting@gmail.com) to schedule a date between April and May for this and other mountain training! **\$150/person for one-on-one | \$99/person for groups of two–five.**

## GUIDED BACKCOUNTRY SKIING AND SNOWBOARDING

**Custom dates through May.** For folks seeking powder and fun lines away from the masses, join us in the backcountry, we are excited to continue to offer our popular guided BC excursions. Our experienced and professionally certified guides will take you out for a day at Monarch Pass for some low ratio instruction. If you are new to BC skiing/riding, this is a great course to learn the basics, and if you have some experience and are looking to push a bigger day and learn some terrain in our area, our guides can get you there! Includes equipment, guides, and transportation. Mid-week and custom dates for just you and your crew also available through May by emailing [usafarrafting@gmail.com](mailto:usafarrafting@gmail.com). **\$139/person.**

## ALPINE/SKI MOUNTAINEERING CUSTOM TRIPS

Have a mountain here in Colorado you've always wanted to climb/ski? Are you training for a big objective and want to elevate your game? Maybe you want to tick off one of the 50 classic climbs in North America? Schedule a custom trip with one of our AMGA Certified guides to accomplish your ultimate Colorado mountain goals. In Colorado, ski mountaineering is best April–June and alpine climbing goes all the way

through Sept. Email [usafarrafting@gmail.com](mailto:usafarrafting@gmail.com) now to schedule your epic day! Trips include guide, transportation, equipment and overnight trips include meals. Two-person max. **\$200+/person, depending on trip type and length.**

### OUTDOOR LASER TAG

If you need to get out of the house, Outdoor Laser Tag is perfect for you! Our field is huge, boasting lots of trees, rocks, bushes, barrels, and pallets to use as cover. We will set up a variety of games that will test your individual skills as well as how well you work together as a team. Meet at USAFA FamCamp. Activity includes refs and needed gear. You can also arrange for a Special Group Arrangement (SGA), perfect for family, friends, units, team building activities, birthdays and more. Email us at [usafarrafting@gmail.com](mailto:usafarrafting@gmail.com) for availability. 10-person min, 40-person max. Must be 9+. **\$15/person | \$225/group of 16 for a private 150-minute session.** Call for details.

### SPECIAL GROUP ARRANGEMENTS AND CUSTOM TRIPS

If you would like us to put together an activity just for you and your crew, let us know! These are perfect for birthdays, squadron activities, family reunions, church groups, youth groups, sports teams, and more. Outdoor laser tag, rock climbing, biking, rafting or almost any of the many activities we offer can be set up around your schedule (with enough notice of course). One ID cardholder may sponsor up to five guests. Contact your Outdoor Adventure Programmers at [usafarrafting@gmail.com](mailto:usafarrafting@gmail.com) and let us do the planning!



**High Risk Activities Worksheet (AF 4391) is required to participate in ANY high risk activity, for ALL Active Duty Personnel. It is required to be completed by Active Duty Personnel before they participate in most of our Outdoor Adventure Programs and submitted to their Commander. This responsibility lies solely on the Active Duty participant.**

**For cancellation policy, please see [usafasupport.com/outdoor-recreation/](http://usafasupport.com/outdoor-recreation/)**



### WHITewater RAFTING

Reach out early to set up your rafting trip for your group or just yourself to ensure reservation availability and make sure you don't miss out on some fun whitewater action this summer!

All trips meet and depart from the east side of the Outdoor Recreation Center (where the camping trailers are parked) at 6:45am and return about 5pm.

All rafting trips include transportation from the Academy to the Arkansas River and back, adding value to your trip. Includes lunch, permits, guides, all rafting equipment, required personal gear. Our primary concern is for your safety. All of our guides are state-certified and hold a First Aid and CPR certification.

### OAP VOLUNTEERS AND RAFT GUIDE TRAINEES WANTED

Our Annual Raft Guide Training begins at the beginning of every April. Every year we train new volunteers and paid guides to come out and have fun on the river. We will guide you through the state licensing process and getting certified as a Colorado state raft guide so you can be on the river all summer long! This training is physically demanding, mentally stimulating, and a great way to learn new skills and become of part of an incredible community of USAFA guides. Our guides are among the best guides on the river. If this sounds fun and exciting to you, come in for an informational meeting on **Wed, March 13 at 5:30pm at the Outdoor Rec Center for more info.**



# INFORMATION, TICKETS & TRAVEL

## Planning a vacation?

Whether you are traveling within Colorado or across the US to your dream destination, USAFA ITT can help arrange your lodging!

From the mountains to the beaches and anywhere in between we've got you covered.

Call us at 719-333-7367 to inquire about lodging options, availability, and rates.

### IN-STATE TICKETS

#### iFly

- 2-Flight Voucher \$67.99
- Family & Friends Pack \$320 (up to 5 people)

#### Boondocks

- (Parker & Northglenn locations)
- 4-hours of play \$32

#### Overdrive Raceway

- 3-Race Ticket \$49

#### Denver Aquarium

- Adult (12+) \$17, Child (3-11) \$10.50

#### Dinosaur Resource Center

- Adult (13+) \$12.50, Child (5-12) \$8.50

#### US Olympic & Paralympic Museum

- Adult (13+) \$16.95, Child (3-12) \$11.95

### ADDITIONAL IN-STATE TICKETS

(Must be purchase through ITT)

#### Royal Gorge Railroad

- Coach Adult (13+) \$83 | Child (2-12) \$76
- Deluxe Adult (13+) \$110 | Child(2-12) \$105
- Vista Dome Adult (13+) \$110 | Child (2-12) \$105

#### The Edge Ziplines and Adventures

- Epic Sky Trek starting at \$48 (4 treks available)
- Zipline Tours starting at \$85 (10 tours available)

*Ticket pricing subject to change without notice. Additional discounted tickets are available for other out-of-state attractions! Call ITT at 719-333-7367 for information and pricing. Blackout dates may apply. All ticket sales final.*

## COLORADO EVENTS

### APRIL

- 1-7 Aspen Film Shortsfest
- 1-14 Springalicious, Steamboat Springs
- 3-6 Taste of Vail
- 4-7 Denver Auto Show
- 6-7 Rocky Mountain Train Show
- 8-11 Space Symposium, Colorado Springs
- 19-21 Colorado Springs Pet Expo
- 26-28 Colorado Springs Home Show
- 27 Runs with Scissors Races
- 27-28 Durango Wine Experience

*All Dates subject to change.*

### OUT-OF-STATE TICKETS

#### 2024 Disney World Salute Tickets

- 4-Day Park Hopper \$369
  - 4-Day Park Hopper Plus \$399
  - 5-Day Park Hopper \$389
  - 5-Day Park Hopper Plus \$419
  - 6-Day Park Hopper \$409
  - 6-Day Park Hopper Plus \$439
- Valid through 12/20/24. Eligibility restrictions apply. Blackout dates may apply.*

#### 2024 Disneyland Salute Tickets

- 3-Day Park Hopper \$264
  - 3-Day Park Hopper Genie+ \$352
  - 4-Day Park Hopper \$309
  - 4-Day Park Hopper Genie+ \$427
- Valid through 12/13/24. Eligibility restrictions apply. Blackout dates may apply.*

#### 2024 Universal Orlando Freedom Passes

- 2-Park Park-to-Park Adult (10+) \$210  
Child (3-9) \$205
- 3-Park Park-to-Park Adult (10+) \$245  
Child (3-9) \$240



Are you in need of a rental car?



CHOOSE ENTERPRISE OR HERTZ, BOTH OFFER EXCELLENT BENEFITS!



# INTERESTED IN ROCK CLIMBING?

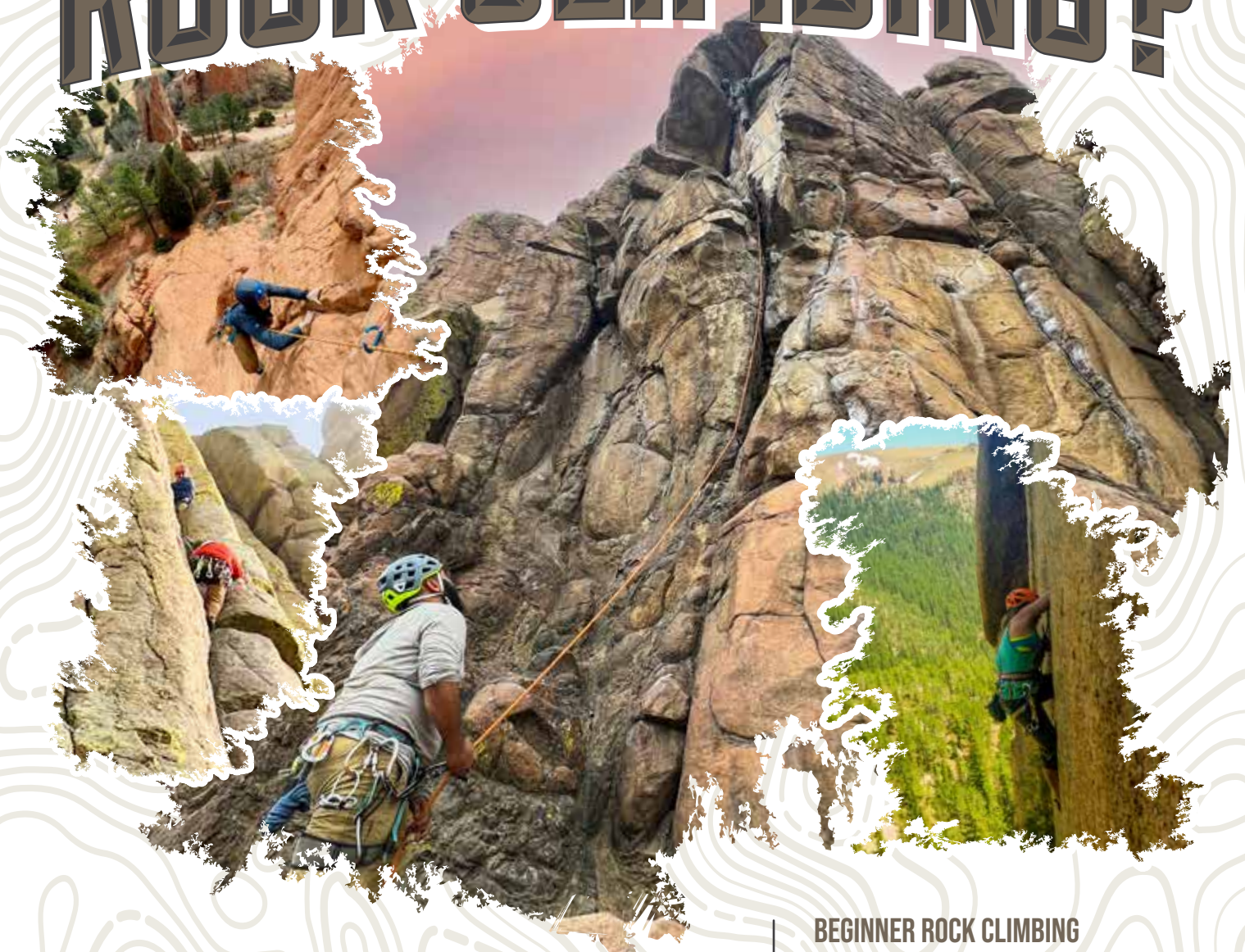

Outdoor Adventure Programs has you covered, we offer many different climbing trips that suit any skill level.

**CALL 719-333-4475 TO RESERVE YOUR SPOT!**

- BEGINNER ROCK CLIMBING
- MULTI-PITCH AND ADVANCED CLIMBING
- DEVIL'S TOWER NATIONAL MONUMENT
- ROCK CLIMBING WEEKEND TRIPS
- MOAB CRACK CLIMBING
- ROCK/ALPINE CLIMBING ON PIKES PEAK
- AMGA CERTIFIED SINGLE PITCH INSTRUCTOR/ROCK GUIDE
- PORTABLE CLIMBING TOWER

# Spring VOLKSMARCH

free 5k & 10k walk  
with outdoor rec

SAT, MAY 4 | START 9 AM - NOON

PREP SCHOOL FOOTBALL FIELD

Registration required. Call 719-333-4475 to register.

Pre-registered walkers will receive a free bratwurst/chips.

You can also  
scan to register



SPONSORED IN PART BY



NO FEDERAL ENDORSEMENT OF  
SPONSOR INTENDED



REC\*ON  
FEED YOUR RUSH!

DEPLOYED  
AFFECTED  
program

SINGLE ★ AIRMAN

## RECHARGE FOR RESILIENCY (R4R) PROGRAMS

**RecOn:** Air Force and Space Force Active Duty, Reserve, Guard personnel and their valid ID family members. These programs are specifically high adrenaline supervised by ODR.

**Single Airman Program (SAPI):** Air Force and Space Force Active Duty, Reserve, and Guard officer or enlisted without a spouse. *Note: new this year SAPI eligible may sponsor one guest at the R4R price.*

**Deployed Affected (DAP):** Deployed affected Air Force and Space Force Active Duty, Reserve, Guard personnel and their family members. The deployed service member and their family are eligible upon receiving official orders during the deployment and up to 1 year after the service member returns to the home station. *Note: new this year DAP eligible families may sponsor one guest at the R4R price.*

Outdoor Rec is offering several programs throughout the year that qualify for R4R pricing including snowmobiling, dogsledding, indoor and outdoor rock climbing, rafting, golf, bowling, and arts and crafts. Please go to [usafasupport.com](http://usafasupport.com) for dates and details, and call 719-333-4753 for more information and to sign up!

**ELIGIBILITY:** *The Recharge for Resiliency (R4R) initiative is directed specifically toward the Active Duty and Reserve members to include their families at each base. Unfortunately this means that retirees, civilians and foreign military are NOT eligible for R4R discounted rates. Other branches of the US military are not eligible unless they are part of an Air Force led joint-based scenario, or are permanently assigned to an Air Force base. Even then, they are only eligible at the Air Force Base in which they are assigned.*



2024 – 2025  
DENVER  
BRONCOS  
SEASON  
TICKET  
LOTTERY

ENTRIES ACCEPTED  
MAY 1 – 31

ONE ENTRY PER HOUSEHOLD  
NO EXCEPTIONS

DoD CARDHOLDERS ONLY

DRAWING WILL BE HELD  
THE FIRST WEEK OF JUNE

CALL ODR FOR MORE INFO

719-333-4475

**RESERVE YOUR SPOT EARLY FOR  
OAP WHITEWATER RAFTING TRIPS  
TO ENSURE AVAILABILITY!**

# WHITEWATER RAFTING



AIR FORCE



ODR

## ADVENTURE RIVER TRIPS

**ROYAL GORGE | BIG HORN SHEEP CANYON**

**FAMILY OVERNIGHT | CUSTOM OVERNIGHT**

Call 719-333-4475 to book a spot on a weekend trip.

Email [usafarrafting@gmail.com](mailto:usafarrafting@gmail.com) for custom trips.



# OUTDOOR RECREATION & FAMCAMP

## APRIL MONTHLY SPECIALS

### RETAIL SPECIAL

15% off summer inventory

### RENTAL SPECIAL

\$5 off aerator rentals

### SERVICE SPECIAL

\$5 off ski/board storage wax



## COMMUNITY GARDEN PLOTS

Plots are available in Pine & Doug Valley for Housing/Dorm Residents. Garden Plot use begins May 10 and ends Oct 10. Garden Plots will be issued by lottery for new users. Last year's users will be grandfathered but must contact Outdoor Rec to notify us of your intent to stay by May 1 or the spot will be offered to new gardeners. If you are interested in being entered into the drawing, please contact ODR at 719-333-4475. **\$50/plot.**

## GENERAL INFO

**April 1** | April Fool's Day

**April 22** | Earth Day

## EQUIPMENT RENTAL

### DAILY SKI/SNOWBOARD RENTALS

Call 719-333-4753 for fitting appointment.

Minimum 2 day rental for ski/board equipment.

**Last day for rentals is April 13.**

**All ski/board equipment is due back by April 16.**

**Ski/repair/maintenance shop closes on April 26.**



## EQUIPMENT RENTAL RESERVATION POLICY

*(high-demand equipment other than skis + campers)*

### CAMPERS AVAILABLE STARTING MAY 10! (DEPENDING ON WEATHER)

Active Duty may reserve 90 days in advance of rental. All other eligible ID card holders may reserve 60 days in advance of rental.

USAFA Picnic Pavilions at Peregrine Pines are available to reserve May-Sep! \$65/day.

Camping equipment and party rentals available through Outdoor Rec!

Reservations are paid for in full at time of reservation. Cancellation fees:

10% of cost if more than 4 days from rental.

50% of cost if within 3 days from rental.

Campers – no refund if cancelled within 10 days of reservation. Exceptions for documented medical or military emergencies.

## CADET OUTDOOR REC AT VANDENBERG HALL

**Mon/Tues/Thur/Fri, 8am – 5pm;**

**Closed Wed, Sat, Sun and Federal Holidays.**

**Closes for summer on April 16.**

## CADET SEASON SKI/ SNOWBOARD RENTALS

Call 719-333-4602 to check availability.

Weekend ski/board rentals are **\$44 and available Fri – Mon. Season equipment is due back no later than Apr 16, 2024.**



## FAMCAMP NOW OPEN!

### SUMMER HOURS:

**April 1–16 | Sun–Sat | 9am–3pm**

**April 17–30 | Sun–Sat | 9am–5pm**

**Starting May 1 | Sun–Thu | 9am–6pm**

**Fri–Sat | 9am–8pm**

### SUMMER RV SITE RATES FOR DoD ID CARDHOLDERS:

*(effective through Oct 31)*

**\$39/night** | Rigs 27' and smaller

**\$44/night** | Rigs larger than 27'

### SPONSORED NON-DoD GUESTS

*(Max stay 14 nights per year)*

**\$44/night** | Rigs 27' and smaller

**\$49/night** | Rigs larger than 27'

**TENT SITES** *(Maximum stay in tent sites is 14 nights per year).*

**\$18/night** | DoD ID cardholders

**\$23/night** | Non-DoD Sponsored guests

*Reminder – IAW AFI 34-101, FamCamp guests may stay a total of 180 days per calendar year.*

## FAMCAMP RESERVATION POLICY

FamCamp reservations for the 2024 summer season can be made 90 days in advance by active duty personnel, 60 days in advance by retirees, DoD civilians, VHIC and all other eligible users.

Cadets/Prep school students are authorized to make reservations a year in advance for visiting family for Graduation and Parents Weekend.

AOG Members are authorized to make reservations a year in advance for alumni events. (These guests must be an AOG member with ID card or sponsored by AOG). Contractors are NOT eligible to stay at FamCamp.

Call 719-333-4980 to make reservations.



# 2024 TRAVEL TRAILER RENTALS



## TRAVEL TRAILER RENTAL PRICES \*MID-MAY - END OF SEPTEMBER

Prices:	Per Night	Fri-Mon	Holiday Weekend	Weekly
10' Tent Trailer	\$75	\$150	\$225	\$375
16' Scamp	\$100	\$200	\$300	\$500
20' Escape	\$125	\$250	\$375	\$625
23' Escape	\$150	\$300	\$450	\$750

\* Generator or Solar Panel highly recommended if site doesn't have electrical hook up. Generator will charge the battery and run 120V including outlets, air conditioning and/or microwave. Solar panel will only charge the battery which powers 12V operations, no a/c, outlets or microwave. Generators and solar panels are half price with camper rental.

## RESERVATION POLICIES:

Active duty may reserve up to 90 days prior to pick up date. All other eligible ID card holders may reserve equipment 60 days in advance of pickup.

## CANCELLATION POLICY:

Full payment is required at time of reservation. There is a 10% cancellation fee will be charged for cancellations up to 10 calendar days prior to reservation pick up date. No refund for cancellations within 10 calendar days of pickup date. Exceptions only for documented military or medical reasons.

## USAFA CAMPING FACILITIES

Peregrine Pines (USAFA) 719-333-4980

Farish Rec Area (Woodland Park) 719-687-9098

*Take it Outside*  
WITH OUTDOOR RECREATION CENTER RENTALS

## 16' SCAMP

SIDE SLIDE - REQUIRED: ODR TRAVEL TRAILER CLASS, CLASS III 2" RECEIVER BALL, TOW CAPACITY 3,000LBS AND NO REQUIRED ELECTRONIC BRAKE CONTROLLER.



MGVW 3,500LBS  
 DRY WEIGHT 2,758LBS  
 CARGO MAX 742LBS  
 INTERIOR HEIGHT 6'3"  
 TABLE CONVERTS TO BED,  
 SOFA CONVERTS TO BUNK BEDS  
 REFRIGERATOR • SINK • PROPANE  
 STOVE TOP • MICROWAVE  
 AIR CONDITIONING & HEATING  
 NO BATHROOM  
 12GAL FRESH WATER TANK  
 2 PROPANE TANKS

## 20' ESCAPE

SIDE SLIDE - REQUIRED: ODR TRAVEL TRAILER CLASS, CLASS III RECEIVER, TOW CAPACITY 4,500LBS AND HAVE A INSTALLED ELECTRONIC BRAKE CONTROLLER

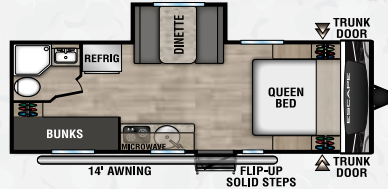

MGVW 4,000LBS  
 DRY WEIGHT 2,915LBS  
 TONGUE WEIGHT 340LBS  
 QUEEN BED • TWO TWIN BUNKS  
 (DINETTE CONVERTS TO TWIN BEDS)  
 AC/DC POWER  
 DUAL OPERATING REFRIGERATOR  
 PROPANE STOVE • MICROWAVE  
 PROPANE HEAT • AIR CONDITIONING  
 SINK • SHOWER • TOILET  
 HOLDING TANKS  
 20GAL FRESH WATER • 30GAL BLACK WATER

## 23' ESCAPE

SIDE SLIDE - REQUIRED: ODR TRAVEL TRAILER CLASS, CLASS III RECEIVER, TOW CAPACITY 5,000LBS AND HAVE A INSTALLED ELECTRONIC BRAKE CONTROLLER

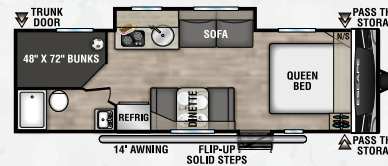

MGVW 4,245LBS  
 DRY WEIGHT 3,470LBS  
 TONGUE WEIGHT 540LBS  
 QUEEN BED • TWO FULL BUNKS  
 (DINETTE AND SOFA CONVERTS TO TWIN BEDS)  
 AC/DC POWER  
 DUAL OPERATING REFRIGERATOR  
 PROPANE STOVE • OVEN • MICROWAVE  
 PROPANE HEAT • AIR CONDITIONING  
 SINK • SHOWER • TOILET  
 HOLDING TANKS  
 20GAL FRESH WATER • 30GAL BLACK WATER

## 10' TEPUI AYER 2 TENT AND TRAILER

REQUIRED: ODR TRAVEL TRAILER CLASS, CLASS III RECEIVER



DRY WEIGHT 600LBS  
 OFF ROAD TRAILER  
 WITH A THULE AYER 2  
 CARTOP TENT  
 SLEEPS TWO



# FARISH RECREATION AREA

## FARISH RECREATION AREA

**FARISH is CLOSED for the winter, tentatively reopening May 3. Once open, office hours are daily from 8am–6pm.**

Reservations Policy: 90 days in advance only for active duty personnel and 60 days in advance for all other eligible users. Customers are authorized to make reservations a year in advance for large events that require at least 50% of all indoor lodging. These groups are only authorized to make reservations during non-peak months (May, Aug, Sept, Oct) and will only be scheduled Sundays to Thursdays (no weekends). All weekends and the months of June and July are for the resiliency of individual families. For more information, call 719-687-9098.

### SUMMER RATES

**\$10/vehicle** | Day-use patrons

**\$400/day** | **Multipurpose building**, call for details.

\$400 First day, \$200/additional day. Day use only, max of 75 people and parking for 15 vehicles with a \$10/additional fee per vehicle. Loft, tables, chairs, projector, screen and full kitchen with two refrigerators.

**\$60-\$110/day** | **Main pavilion, day use only.**

*\$60/day*, up to 25 guests

*\$110/day*, up to 75 guests

Includes parking for a 30 vehicles.

*\$10/additional vehicle.*

### MAY-OCT LODGING RATES

**\$200/night** | **The Cottage**

Sleeps eight, with two bedrooms, a fireplace, kitchen, bath and sheets provided.

**Bring pillows and blankets.**

**\$145/night** | **Duplexes**

Six units total, each unit sleeps five microwave stove-top (no oven).

Two units with two bedrooms are pet friendly for a \$25 fee.

Four units w/one bedroom with loft

**Sheets provided, bring your own pillows and blankets.**

**\$65-\$90/night** | **The Lodge** | **Four rooms**

*\$90 Room One* - Sleeps five with fireplace and private bath

*\$65 Room Two* - sleeps four

*\$75 Room Three* - sleeps four, with fireplace

*\$65 Room Four* - two rooms, sleeps four

Rooms two, three and four have a shared hallway bathroom. All rooms have cookware and access to a shared kitchen.

**Sheets provided, bring your own pillows and blankets.**

**\$140/night** | **Grace Lake Barn**

Available for overnight use, sleeps twelve in open bay. Covered outdoor pavilion with electricity, indoor refrigerator and microwave.

### \$50-\$65/night | Camper Cabins

*\$55 Cabins 1 and 2* - sleeps four, with electricity

*\$50 Cabins 3-5 and 7-8* - sleeps four, without electricity

*\$65 Cabin 6* - sleeps eight, without electricity

*\$65 Cabin 9* - sleeps eight, without electricity

**All cabins require renter to bring sheets, pillows and blankets.**

### \$25/night | Campsites

Six-person maximum and two vehicles per campsite. Each site has a picnic table and firepit. Sites 26, 30, 31, 32 have a max space for a 15' trailer/camper. Lake Leo sites are lake front walk-in sites (*vehicles must be parked in adjacent parking lot*).

### \$25-\$40/day | RV Sites

*\$25/day Hill Top One* - No electric, accommodates up to a 32' rv/camper.

*\$40/day Pavillion Three* -15 amp electric hook-up, accommodates up to 20' rv/camper.

*\$40/day Pavillion Four* -15 amp electric hook-up, accommodates up to 40' rv/camper

*\$40/day Pavillion Five* -15 amp electric hook-up, accommodates up to 32' rv/camper



# EQUESTRIAN CENTER

## GUIDED GROUP TRAIL RIDES

Join us for guided group trail rides by reservation only. Visit our webpage at [usafasupport.com/equestrian-center/](http://usafasupport.com/equestrian-center/) for the schedule and to sign up online or please call 719-333-4607. This is an excellent way for beginners to gain riding experience and for seasoned riders to learn the trails!

**1-hour guided rides \$60/person, add \$10/guest for non-DoD cardholders.**

## HORSEMANSHIP LESSONS

Sign up for our English/Western horsemanship lessons. For ages 8 & up (ages 6-7 are on a case-by-case basis). Lessons include instruction on riding, grooming, saddling, and proper etiquette. Call 719-333-4607 to request information and to schedule with an instructor.

## GROUP/SPECIAL EVENTS

Call us at 719-333-4607 to schedule group and special events!

## SUMMER CAMPS

**Summer camps start in June!**

**Sign-ups begin April 30 at 10am.**

**In-person signups - Equestrian Center.**

**Phone signups - Call ODR at 719-333-4475.**

Make in-person signups at the Equestrian Center and phone signups by calling Outdoor Rec

Our riding instructors will be available in person on April 30th at 10am at the Equestrian Center Rental Office to answer questions. For camp information prior to sign-ups call 719-333-4607.

## LEAD LINES/MINI HORSES

Rent a horse and help your child gain experience as you lead them around on the horse! Lead lines are for children ages six-twelve. Children under age six may rent one of our mini horses to groom/lead, with a parent (no riding). By reservation only, call 719-333-4607. **\$25/30 minutes.**

## TRAILER-INS

Did you know you can trailer your own horse in to ride on our trails? Call 719-333-4607 for more information.

**Daily Fee \$10 (via drop box).**

**Yearly Pass \$120 (at rental office).**

## HORSE BOARDING

Eligible patrons may board their horse(s) at the Equestrian Center!

Many boarding options are available for eligible ID cardholders. Call 719-333-2294 for pricing and details.

## UNITE PROGRAM

Have Unite Funds you need to spend? Come down to the Equestrian Center and enjoy a relaxing team trail ride outing. For more information, call 719-333-4037.

United States Air Force Academy

Rocky Mountain  
**BLUE**  
AT KEYSTONE RESORT

**KEYSTONE**



relaxation



lodging



fun

GREAT  
PRICES  
JUST FOR  
*You!*

# MAKING MEMORIES!

An ultimate family  
spring vacataion  
through  
Rocky Mountain Blue  
at Keystone Resorts

**THE ROCKY MOUNTAIN BLUE AIR FORCE**  
partnership with Keystone Resorts in Colorado offers  
the military the best in lodging, recreation,  
conferences and reunions.

**RMB WELCOMES**  
personnel from Air Force, Army, Navy, Marines,  
Coast Guard, Reserves, National Guard, DoD  
employees, retired military, immediate  
family members and their guests.



## Book now!

**CALL TOLL FREE 866.768.2583**

Visit [usafasupport.com/rocky-mountain-blue/](http://usafasupport.com/rocky-mountain-blue/)

or call





# 4 DAYS RAFTING ON THE LOWER GRAND CANYON



**MAY 23-27**

**R4R \$800/PERSON**

— \$1,800 REGULAR PRICE —



**TRIP INCLUDES:**

- Professional Guides
- Transportation & Lodging
- Camping Equipment
- Personal Gear Dry Bag
- Food, Coffee & Water

*Don't miss this once in a lifetime trip*

4 days of rafting the Diamond Down in the lower Grand Canyon! We will cover 54-miles of river between Diamond Creek and Pearce Ferry. Come join us as we experience adrenaline-filled rapids, breathtaking scenery, unique hikes featuring exciting new terrain and a stunning waterfall, camping on sandy beaches beneath the stars, and share camp-side cooked meals.