

ADVENTURE

OUTDOOR RECREATION AND ADVENTURE EVENTS & ACTIVITIES
★ ★ ★ JUNE ★ ★ ★



ROCK CLIMBING ★ WHITEWATER RAFTING ★ BIKING





OUTDOOR ADVENTURE ACTIVITIES

WHITewater RAFTING

All trips meet and depart from the east side of the Outdoor Recreation Center (where the camping trailers are parked) at 6:45am and return about 5pm.

All rafting trips include transportation from USAFA Outdoor Rec to the Arkansas River and back. Includes all rafting equipment, lunch, permits, and guides. Our primary concern is for your safety. All guides are state-certified and hold a First Aid and CPR certification.

ROYAL GORGE FULL DAY CLASS IV-V

Every Sat and Sun through Sep 1.

Our trips always operate on class IV-V whitewater and may include sections of river such as the Royal Gorge and Bighorn Sheep Canyon depending on water levels. This trip is for folks who want to step up the adrenaline and feel the thunder! Not for the meek or weak! Custom dates are available mid-week at the regular price by emailing usafarrafting@gmail.com.

Ages 16+ | 50lbs+ | \$149/person | R4R \$99/person

BIGHORN FULL DAY CLASS III (IV IN HIGH WATER)

Every Sat and Sun through Sep 1.

Our family class rafting trips are great for first-timers, groups of varying experience, kids, and family/squadron fun. These trips operate on class III whitewater, and during the early season, sometimes have one or two class IV rapids. Bighorn Sheep Canyon is our primary location for this trip. Custom dates are available mid-week at the regular price by emailing usafarrafting@gmail.com.

\$129/Adult | Ages 13+

\$119/Child | Ages 7-12 | 50lbs+

R4R \$79/Adult | Ages 13+

R4R \$69/Child | Ages 7-12 | 50lbs+



BROWNS CANYON FULL DAY CLASS III (IV IN HIGH WATER)

With whitewater like our family class rafting trips, Browns Canyon is a more remote feeling stretch of river with awesome scenery. With exciting whitewater rapids such as Big Drop, Raft Ripper, Widowmaker and more, this trip is fun for all ages. Available for private parties of ten or more participants. To schedule your trip, email usafarrafting@gmail.com. Ages 8+ | 50lbs+ \$149/Adult | \$139/Child

ADVENTURE OVERNIGHT TRIP

Jun 22-23. On day one you'll get warmed up on class II-III rapids. Come in to camp and have a hearty dinner made by our staff. Camp out and share stories next to the fire and get ready for the next day of adrenaline filled rapids! Paddle a guided raft down the Royal Gorge!

Ages 16+ | 50lbs+ | \$319/person | R4R \$160/person

DUCKY DAYS

8-3pm. Burn away those hot July and August days on the river in your own inflatable kayak. "Duckies", as we call them, are one of the most fun ways to experience the river without needing a great deal of experience. We will take you to a section with a couple rapids and fun float sections. This is a great way to float away the day! Includes lunch and necessary equipment. Max of eight people. Custom trips available. Email usafarrafting@gmail.com to schedule your day! Ages 12+ | \$119/person

OVERNIGHT RAFT TRIPS

Overnighters include all rafting gear for both days (helmet, PFD, Wetsuit, splash top), tent, sleeping bag, sleeping pad, two lunches, one dinner and breakfast, and transportation.

KAYAKING

LEARN TO KAYAK POOL SESSION

June 11 | July 9 | 8-10pm.

This event is at the Fitness Center pool. Four participant minimum. This course is designed for first-time kayakers to come and learn basic skills, including basic paddle strokes, boat control, balance, and T-rescues. Includes kayak, paddle, and ACA Certified Kayak Instructor. Ages 9+ | 75lbs+ | \$35/person

KAYAK FAST TRACK PROGRAM

To schedule your custom all-inclusive, intensive kayaking instruction trip for you and your group, email usafarrafting@gmail.com.

INTRO TO KAYAKING CLASS

Intro to kayak roll in a pool, a lake session, and intro river trip are all included. Includes transportation and all gear. Ages 9+ | 75lbs+ 3-6 participants | \$299/person

SPLASH DAYS

Schedule your group for a private program! We bring floatable watercraft, such as stand-up paddleboards, pedal kayaks, a raft or two, as well as a few other crafts to Kettle Lakes on base for you to try out and play in the water. If you need instruction on any of the watercraft, just ask. Enjoy provided grilled food and refreshments. Reserve your spot at least 72 hours in advance. Ages 9+ | 50lbs+ for water activities | \$35/person

HIGH WATER REGULATIONS

During high water season (over 3200 cfs), typically at the end of May and beginning of June, rafters must be a minimum of 12 years old and 90 lbs. In extreme high water (over 4500 cfs), the Royal Gorge is closed and rafters must be a minimum of 16 years old and 90 lbs for other sections of the river.

ROCK CLIMBING

BEGINNER ROCK CLIMBING

Jun 15, 23 | Jul 13, 20 | 7am – 3pm.

Learn the basic skills and techniques for this popular Colorado sport. Participants must be nine years or older (any minors must be accompanied by an adult). Activity includes transportation, necessary technical gear and an AMGA Certified Single Pitch Instructor/Rock Guide.

\$109/person | R4R \$35/person

AMGA SINGLE PITCH INSTRUCTOR COURSE/ASSESSMENT

Course: June 21-23 | Assessment: June 1-2.

Are you interested in learning more about climbing instruction and the professional side of the industry, or learning some industry “best practice” skills for single pitch climbing with your friends and family? These programs set you up for success with accredited, national level training in the industry professional standard for single pitch rock climbing instruction and skill sets, and are taught by AMGA/IFMGA Licensed Mountain Guides and SPI Providers. The three-day initial course teaches top rope systems managed from above and below, belay and rescue systems, and teaches techniques to help your students thrive in this new skill. The two-day assessment examines proficiency with these skills and allows the candidate to achieve certification through the American Mountain Guides Association as a Single Pitch Instructor

when they pass. Prerequisites are required for entry into both the course and assessment programs. Custom dates available. Includes instructors, accreditation fees, transportation. Does not include AMGA professional membership required for course/assessment participation. Email usafarafting@gmail.com for more information and to sign up.

Course: \$500/person | R4R \$375/person

Assessment: \$450/person | R4R \$250/person

CLIMBING DEVELOPMENT SERIES: GYM TO CRAG

Course 1: June 29-30 & July 6-7.

Course 2: Aug 24-25, 31 & Sep 1.

These separate four-day courses take place over two consecutive weekends with eight hours per day of instruction which is designed to take you through the basics and into more advanced topics. Whether you have some previous experience or are brand new to outdoor rock climbing, this is the course for you. We will focus on specific skills and techniques to improve knowledge base as well as individual learning outcomes for students. Activity includes transportation, necessary technical gear, and an AMGA Certified Single Pitch Instructor/Rock Guide.

Ages 12+ | \$500/person | R4R \$275/person

PORTABLE CLIMBING TOWER

This is a great activity to pair with a party, squadron event, or BBQ. Our portable climbing tower can accommodate up to four climbers at a time, stands 35 feet tall, and comes with all the staff and necessary equipment. Schedule a 4-6 hour day and get all your guests climbing up the tower! Email usafaoutdoorrec@gmail.com to schedule a climbing tower program at our FamCamp this summer! **Ages 7+ | 50lbs+ | \$600 for 4 hours, \$800 for 6 hours**

ROCK/ALPINE CLIMBING ON PIKES PEAK

Climb in our very own backyard alpine playground this season on America’s Mountain with our in-house IFMGA American Mountain Guides! As the only MWR program in the DoD with Licensed Mountain Guides, we have the local knowledge and highest-level guides to take you higher on Pikes Peak. Multi-pitch rock, Intro to Mountaineering and alpine scrambles await this summer for you to experience the magic of the alpine! Email usafarafting@gmail.com to schedule your private day out with us! Includes transportation and required equipment.

Prices start at \$139/person and vary based on number of people and objective.

MULTI-PITCH AND ADVANCED CLIMBING TRIPS

Learn how to build climbing anchors, climb longer routes with multiple pitches, place and lead on traditional protection, and most importantly, get you off the ground higher than you have ever been with an AMGA/IFMGA Licensed Mountain Guide. Includes guide, transportation, needed technical gear, and a custom curriculum to suit your desired outcomes. Email usafarafting@gmail.com to schedule your custom trip this season.

Prices start at \$129/person, and vary by number of people and trip objectives.

CUSTOM TRIPS

Our AMGA Certified Single Pitch Instructors, Rock Guides and IFMGA Mountain Guides can help you achieve your climbing goals! Whether you are looking to build skills and become self-sufficient, or are wanting to hire a guide to get you up a route you’ve been drooling over, we can get you there! We can guide in many areas of Colorado including Pikes Peak, the South Platte, Garden of the Gods, Rocky Mountain National Park and beyond! We also guide in some of the most coveted climbing destinations such as Devil’s Tower National Monument, Moab, and Indian Creek. Schedule your dream climbing trip and take advantage of our in-house pros with custom inclusions. Email usafarafting@gmail.com to build your ultimate adventure this season!



High Risk Activities Worksheet (AF 4391) is required to participate in ANY high risk activity, for ALL Active Duty Personnel. It is required to be completed by Active Duty Personnel before they participate in most of our Outdoor Adventure Programs and submitted to their Commander. This responsibility lies solely on the Active Duty participant.

**FOR CANCELLATION POLICY, PLEASE SEE
USAFASUPPORT.COM/OUTDOOR-RECREATION/**



OUTDOOR ADVENTURE ACTIVITIES

BIKING TRIPS

For all Biking Activities: Bikes are available for rent at a discounted rate through Outdoor Rec but must be reserved at least three days prior to the date of the activity.

PHANTOM CANYON DOWNHILL BIKE RIDE

Jun 1 | 8:30am – 5:30pm.

This exciting downhill bike ride through the scenic Phantom Canyon features a 3,713-foot drop in elevation over 23 miles, with zero climbing. Beautiful views, tight canyon walls, and tunnels make this our most popular single-day bike event. Includes transportation, guide, support, and sack lunch/dinner. This is an old narrow gauge railroad line converted to a dirt road with following vehicle support, not singletrack.

Ages 12+ | \$89/person | R4R \$39/person

BIKE DOWN PIKES PEAK

Jun 15 | Jul 5 | 8:30am – 5pm.

Enjoy the downhill ride of a lifetime on a route offering a 7,000 foot drop in elevation over about 21 miles. Meet at Outdoor Rec, load the bikes and drive up to the summit of Pikes Peak. At the end of the ride, we'll stop at Rudy's restaurant before we head home (not included in price). Includes transportation, Pike's Peak entry, guides, and snacks. This is a paved road with vehicle support.

Ages 14+ | 4'9" | \$99/person | R4R \$49/person

PHANTOM CANYON AT NIGHT DOWNHILL BIKE RIDE

Jun 21 | Jul 19 | 5:30pm – Midnight.

This is a great year for full moon, or almost full moon, bike rides down Phantom Canyon! This exciting downhill bike ride through the scenic Phantom Canyon features a 3,713-foot drop in elevation over 23 miles, with zero climbing. Beautiful views, tight canyon walls, and tunnels make this our most popular single-day bike event, but at night under the full moon it is a whole new experience. You will need to bring your own headlight and a mandatory tail light. Includes transportation, guide, support, and sack lunch/dinner. This is an old narrow gauge railroad line converted to a dirt road with following vehicle support, not single track.

Ages 12+ | \$89/person | R4R \$39/person



OUTDOOR LASER TAG

Jun 2 | Jul 6 | Peregrine Pines FamCamp

Laser guns use a harmless invisible infrared beam that shoots 1,000+ feet at the speed of light with zero drop. You are not going to dodge this like you can a paintball! Our field is huge with lots of trees, rocks, bushes, barrels, and pallets to use as cover. We will set up a variety of games that will test your individual skills as well as how well you work together as a team. You can also arrange for a Special Group Arrangement (SGA), perfect for groups, units, team building activities, birthdays and more. For details, email usafarafting@gmail.com.

Ages 9+ | \$15/person | \$225 for 15 or more

DUTCH OVEN COOKING CLASS

Jun 28 | Jul 12 | 5:30 – 9pm.

Whether you want to learn to cook in a Dutch oven and don't know where to start, or maybe you just want to make some new friends, join this unique class. Be the envy of the campground, learn proper heat management techniques, and try some great recipes. We will cook up an entire meal, and since the best part is sitting down to eat your work at the end of class, bring your hunger! Class and recipes are planned as if you were camping, so cook times are 30–60 minutes long and ingredients are camp-friendly. Includes Dutch ovens and food. (If you have food allergies or restrictions, we respectfully ask that you do not attend this class). **\$30/oven, and you can bring one guest for free. Class is limited to 8 ovens, so sign up early.**

SPECIAL GROUP ARRANGEMENTS AND CUSTOM TRIPS

If you would like us to put together an activity just for you and your crew, let us know! These are perfect for birthdays, squadron activities, family reunions, church groups, youth groups, sports teams, and more. Outdoor laser tag, rock climbing, biking, rafting or almost any

of the many activities we offer can be set up around your schedule (with enough notice of course). One ID cardholder may sponsor up to five guests. Contact your Outdoor Adventure Programmers at usafarafting@gmail.com and let us do the planning!

OAP VOLUNTEERS WANTED

If you are interested in volunteering your time to help us with rafting, biking, climbing, kayaking, hiking, or any other trips we offer, give us a call and we will tell you how to become an official OAP volunteer!

ADULT CPR CLASS

8am – 3pm | 30-min. lunch break.

Get your American Red Cross Adult/Child CPR, AED, and First Aid Certification with Certified Red Cross Instructors. We teach Adult/Child CPR, AED and First Aid, rescue breathing, procedures for choking victims and more First Aid training. Our goal is to teach you the skills so that in the event of an emergency you will have the skills and confidence to assist someone in need.

Certification is good for two years and is only five-person minimum, ten-person maximum.

This is not a babysitter course, must be 18+. \$75/person. Call for dates.

ADULT CPR RECERTIFICATION

Recertify your American Red Cross Adult/Child CPR, AED, and First Aid. This is a hybrid recertification course that includes a three-hour online training and a two-hour in-person skills test. Online training link will be sent to you one week prior to the scheduled skills test and must be completed before attending the skills class.

Registration will close one week prior to the scheduled skills test. You must provide proof of previous certification and not exceed expiration of certification by more than 30 days. Contact ODR for more information at 719-333-4475.

This is not a babysitter course, must be 18+ Call for dates | \$50/person

TAKE IT OUTSIDE!



FREE BEGINNERS CLASS!



REGISTRATION IS
REQUIRED BY CALLING
ODR AT 719-333-4475.
ALL RENTERS MUST
ATTEND THE REQUIRED
SAFETY/OPERATIONS
BRIEFING. MINIMUM AGE
TO RIDE IS 14 YEARS-OLD.



RENTAL PRICES

GT

Day rental \$40/person.
Overnight rental \$50/person.

pint 

Day rental \$30/person.
Overnight rental \$40/person.

OUTDOOR REC
719-333-4475





OUTDOOR RECREATION, R4R & FAMCAMP

JUNE MONTHLY SPECIALS

RETAIL SPECIAL

10% OFF Hiking Socks and Sticks

RENTAL SPECIAL

\$5 OFF Weekend Camping
Equipment Rental (2-night min)

GENERAL INFO

June 7 | National Donut Day
Stop in for a free donut and coffee while supplies last.

June 14 | Flag Day

June 16 | Father's Day

June 19 | Juneteenth | ODR/ITT closed

COMMUNITY GARDEN PLOTS

Plots are available in Pine & Doug Valley for Housing/Dorm Residents. Garden Plot use begins May 10 and ends Oct 10. Garden Plots will be issued by lottery for new users. Last year's users will be grandfathered but must contact Outdoor Rec to notify us of your intent to stay by May 1 or the spot will be offered to new gardeners. If you are interested in being entered into the drawing, please contact ODR at 719-333-4475. **\$50/plot.**



EQUIPMENT RENTAL

Camping equipment and party equipment rentals are available for rent.

Picnic pavilions at Peregrine Pines FamCamp are available to reserve through Sep. **\$65/day.** Go to usafasupport.com/outdoor-recreation/ for equipment information and prices.

Active Duty may reserve 90 days in advance of rental date. All other eligible ID card holders may reserve 60 days in advance of rental date.

Full payment is required at time of reservation.

EQUIPMENT RENTAL CANCELLATION POLICY

Cancellation fee of 10% if canceled four or more days in advance, and 50% if canceled three or less days in advance.



FAMCAMP

SUMMER HOURS:

Sun – Thu 9am – 6pm | Fri – Sat 9am – 8pm

SUMMER RV SITE RATES FOR DoD ID CARDHOLDERS:

\$39/night | Rigs 27' and smaller

\$44/night | Rigs larger than 27'

SPONSORED NON-DoD GUESTS

(Max stay 14 nights per year)

\$44/night | Rigs 27' and smaller

\$49/night | Rigs larger than 27'

TENT SITES (Maximum stay in tent sites is 14 nights per year).

\$18/night | DoD ID cardholders

\$23/night | Non-DoD Sponsored guests

(All prices are effective through Oct 31.)

Reminder – IAW AFI 34-101, FamCamp guests may stay a total of 180 days per calendar year.



RECHARGE FOR RESILIENCY (R4R) PROGRAMS

RecOn: Air Force and Space Force Active Duty, Reserve, Guard personnel and their valid ID family members. These programs are specifically high adrenaline supervised by ODR.

Single Airman Program (SAPI): Air Force and Space Force Active Duty, Reserve, and Guard officer or enlisted without a spouse. *Note: new this year SAPI eligible may sponsor one guest at the R4R price.*

Deployed Affected (DAP): Deployed affected Air Force and Space Force Active Duty, Reserve, Guard personnel and their family members. The deployed service member and their family are eligible upon receiving official orders during the deployment and up to 1 year after the service member returns to the home station. *Note: new this year DAP eligible families may sponsor one guest at the R4R price.*

Outdoor Rec is offering several programs throughout the year that qualify for R4R pricing including snowmobiling, dogsledding, indoor and outdoor rock climbing, rafting, golf, bowling, and arts and crafts. Please go to usafasupport.com for dates and details, and call 719-333-4753 for more information. For R4R discount, trip enrollment must be in person with ID card present.

ELIGIBILITY: *The Recharge for Resiliency (R4R) initiative is directed specifically toward the Active Duty and Reserve members to include their families at each base. Unfortunately this means that retirees, civilians and foreign military are NOT eligible for R4R discounted rates. Other branches of the US military are not eligible unless they are part of an Air Force led joint-based scenario, or are permanently assigned to an Air Force base. Even then, they are only eligible at the Air Force Base in which they are assigned.*

RESERVATION/ CANCELLATION POLICY

FamCamp reservations for the 2024 summer season can be made 90 days in advance by active duty personnel, 60 days in advance by retirees, DoD civilians, VHIC and all other eligible users.

Cadets/Prep school students are authorized to make reservations a year in advance for visiting family for Graduation and Parents Weekend.

AOG Members are authorized to make reservations a year in advance for alumni events. (These guests must be an AOG member with ID card or sponsored by AOG). Contractors are NOT eligible to stay at FamCamp.

Call 719-333-4980 to make reservations.

2024 TRAVEL TRAILER RENTALS



TRAVEL TRAILER RENTAL PRICES *MID-MAY - END OF SEPTEMBER

Prices:	Per Night	Fri-Mon	Holiday Weekend	Weekly
10' Tent Trailer	\$75	\$150	\$225	\$375
16' Scamp	\$100	\$200	\$300	\$500
20' Escape	\$135	\$270	\$405	\$675
23' Escape	\$160	\$320	\$480	\$800

* Generator or Solar Panel highly recommended if site doesn't have electrical hook up. Generator will charge the battery and run 120V including outlets, air conditioning and/or microwave. Solar panel will only charge the battery which powers 12V operations, no a/c, outlets or microwave. Generators and solar panels are half price with camper rental.

RESERVATION POLICIES

Active duty may reserve up to 90 days prior to pick up date. All other eligible ID card holders may reserve equipment 60 days in advance of pickup.

CANCELLATION POLICY

Full payment is required at time of reservation. A 10% cancellation fee will be charged for cancellations up to 10 calendar days prior to reservation pick up date. No refund for cancellations within 10 calendar days of pickup date. Exceptions only for documented military or medical reasons.

USAFA CAMPING FACILITIES

Peregrine Pines (USAFA) 719-333-4980

Farish Rec Area (Woodland Park) 719-687-9098

Take it Outside
WITH OUTDOOR RECREATION CENTER RENTALS

16' SCAMP

SIDE SLIDE - REQUIRED: ODR TRAVEL TRAILER CLASS, CLASS III 2" RECEIVER BALL, TOW CAPACITY 3,000LBS AND NO REQUIRED ELECTRONIC BREAK CONTROLLER.



MGVW 3,500LBS
 DRY WEIGHT 2,758LBS
 CARGO MAX 742LBS
 INTERIOR HEIGHT 6'3"
 TABLE CONVERTS TO BED,
 SOFA CONVERTS TO BUNK BEDS
 REFRIGERATOR • SINK • PROPANE
 STOVE TOP • MICROWAVE
 AIR CONDITIONING & HEATING
 NO BATHROOM
 12GAL FRESH WATER TANK
 2 PROPANE TANKS

20' ESCAPE

SIDE SLIDE - REQUIRED: ODR TRAVEL TRAILER CLASS, CLASS III RECEIVER, TOW CAPACITY 4,500LBS AND HAVE A INSTALLED ELECTRONIC BRAKE CONTROLLER

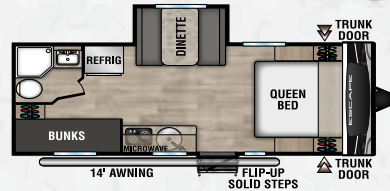

MGVW 4,000LBS
 DRY WEIGHT 2,915LBS
 TONGUE WEIGHT 340LBS
 QUEEN BED • TWO TWIN BUNKS
 (DINETTE CONVERTS TO TWIN BEDS)
 AC/DC POWER
 DUAL OPERATING REFRIGERATOR
 PROPANE STOVE • MICROWAVE
 PROPANE HEAT • AIR CONDITIONING
 SINK • SHOWER • TOILET
 HOLDING TANKS
 20GAL FRESH WATER • 30GAL BLACK WATER

23' ESCAPE

SIDE SLIDE - REQUIRED: ODR TRAVEL TRAILER CLASS, CLASS III RECEIVER, TOW CAPACITY 5,000LBS AND HAVE A INSTALLED ELECTRONIC BRAKE CONTROLLER

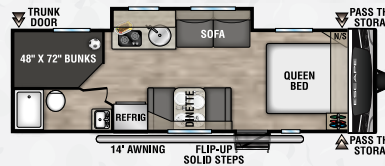

MGVW 4,245LBS
 DRY WEIGHT 3,470LBS
 TONGUE WEIGHT 540LBS
 QUEEN BED • TWO FULL BUNKS
 (DINETTE AND SOFA CONVERTS TO TWIN BEDS)
 AC/DC POWER
 DUAL OPERATING REFRIGERATOR
 PROPANE STOVE • OVEN • MICROWAVE
 PROPANE HEAT • AIR CONDITIONING
 SINK • SHOWER • TOILET
 HOLDING TANKS
 20GAL FRESH WATER • 30GAL BLACK WATER

10' TEPUI AYER 2 TENT AND TRAILER

REQUIRED: ODR TRAVEL TRAILER CLASS, CLASS III RECEIVER



DRY WEIGHT 600LBS
 OFF ROAD TRAILER
 WITH A THULE AYER 2
 CARTOP TENT
 SLEEPS TWO



FARISH RECREATION AREA



SUMMER HOURS: 8am – 6pm.

Reservations Policy: 90 days in advance only for active duty personnel and 60 days in advance for all other eligible users. Customers are authorized to make reservations a year in advance for large events that require at least 50% of all indoor lodging. These groups are only authorized to make reservations during non-peak months (May, Aug, Sept, Oct) and will only be scheduled Sundays to Thursdays (no weekends). All weekends and the months of June and July are for the resiliency of individual families. For more information, call 719-687-9098.

DAY USE SUMMER RATES

\$10/vehicle | Day-use patrons

\$400/day | Multipurpose building, call for details.

\$400 First day, \$200/additional day. Day use only, max of 75 people and parking for 15 vehicles with a \$10/additional fee per vehicle. Loft, tables, chairs, projector, screen and full kitchen with two refrigerators.

Main pavilion, day use only.

\$60/day, 25 guests, parking for 15 vehicles

\$110/day, 75 guests, parking for 30 vehicles

\$10/additional vehicle.



EQUESTRIAN CENTER

GUIDED GROUP TRAIL RIDES

Join us for guided group trail rides by reservation only. This is an excellent way for beginners to gain riding experience and for seasoned riders to learn the trails!

1-hour guided rides \$65/person, add \$10/guest for non-DoD cardholders.

2-hour guided rides \$115/person, add \$10/guest for non-DoD cardholders.

MOONLIGHT GUIDED GROUP TRAIL RIDES

Join us for a moonlit guided ride at 9pm under the full moon through our pastures and trails.

June 20 | Strawberry Moon Moonlight Ride

1-hour guided rides \$80/person, add \$10/guest for non-DOD cardholders.

HOLIDAY HAYRIDES

June 16 | Father's Day

30-minute hayride \$10/person

Ride through the Equestrian Center and surrounding pastures.

LODGING RATES THROUGH OCT

\$200/night | The Cottage

Sleeps eight, with two bedrooms, kitchen, bath and sheets provided.

Bring pillows and blankets.

\$145/night | Duplexes

Six units total, each unit sleeps five microwave stove-top (no oven).

Two units with two bedrooms are pet friendly for a \$25 fee/night.

Four units w/one bedroom with loft

Sheets provided, bring your own pillows and blankets.

The Lodge | Four rooms

\$90 Room One - sleeps four with private bath

\$65 Room Two - sleeps four

\$75 Room Three - sleeps four

\$65 Room Four - sleeps two

Rooms two, three and four have a shared hallway bathroom. All rooms have cookware and access to a shared kitchen.

Sheets provided, bring your own pillows and blankets.

\$140/night | Grace Lake Barn

Available for overnight use, sleeps twelve in open bay. Covered outdoor pavilion with electricity, indoor refrigerator and microwave.

Camper Cabins

\$55 Cabins 1 and 2 - sleeps four, with electricity

\$50 Cabins 3-5 and 7-8 - sleeps four, without electricity

\$65 Cabin 6 - sleeps eight, without electricity

\$65 Cabin 9 - sleeps eight, without electricity

All cabins require renter to bring sheets, pillows and blankets.

\$25/night | Campsites

Six-person maximum and two vehicles per campsite. Each site has a picnic table and firepit. Sites 26, 30, 31, 32 have a max space for a 15' trailer/camper. Sites 27 & 29 can't accommodate any size campers. Lake Leo sites are lake front walk-in sites (*vehicles must be parked in adjacent parking lot*).

RV Sites

\$25/day Hill Top One - No electric, accommodates up to a 32' rv/camper

\$40/day Pavilion Three -15 amp electric hook-up, accommodates up to 20' rv/camper

\$40/day Pavilion Four -15 amp electric hook-up, accommodates up to 40' rv/camper

\$40/day Pavilion Five -15 amp electric hook-up, accommodates up to 32' rv/camper

GROUP/SPECIAL EVENTS

Call us at 719-333-4607 to schedule group and special events!

LEADLINE, MINI HORSE, & PHOTO SHOOT HORSE RENTALS

Rent a horse and help your child gain experience as you lead them around on the horse! Lead lines are for children ages six through twelve.

Children under age six may rent one of our mini horses to groom/lead, with a parent (no riding).

Rent a horse or mini to use in your individual/family photos at the Equestrian Center! Under 18 requires adult supervision/assistance (no riding).

\$25 per 30/minutes for lead lines/mini horse/horse for photos rental.

TRAILER-INS

Did you know you can trailer your own horse in to ride on our trails? Call 719-333-4607 for more information.

Daily Fee \$10 (via drop box).

Yearly Pass \$120 (at rental office).

SUMMER CAMPS

Summer camps are happening now! For more information and registration, call 719-333-4607.

Beginner Session: very little to no riding experience, or for timid riders. Ages 6-7 & 8-17.

Intermediate Session: comfortable riding at walk and trot/jog in arena. Ages 8-17.

Advanced Session: comfortable riding at walk, trot/jog, and canter/lope in arena. Ages 8-17.

UNITE PROGRAM

Have Unite Funds you need to spend? Come down to the Equestrian Center! For more info, call 719-333-4037.

HORSE BOARDING

Eligible patrons may board their horse(s) at the Equestrian Center! Many boarding options are available for eligible ID cardholders. For pricing and details, call 719-333-2294.

Visit usafasupport.com/equestrian-center/ to sign up online or call 719-333-4607.



INTERESTED IN ROCK CLIMBING?



Outdoor Adventure Programs has you covered. We offer many different climbing trips that suit any skill level.

CALL 719-333-4475 TO RESERVE YOUR SPOT!

BEGINNER ROCK CLIMBING
MULTI-PITCH AND ADVANCED CLIMBING
DEVIL'S TOWER NATIONAL MONUMENT
ROCK CLIMBING WEEKEND TRIPS
MOAB CRACK CLIMBING
ROCK/ALPINE CLIMBING ON PIKES PEAK
AMGA CERTIFIED SINGLE PITCH
INSTRUCTOR/ROCK GUIDE
PORTABLE CLIMBING TOWER
SUMMIT SISTERS ROCK CLIMBING



INFORMATION, TICKETS AND TRAVEL

Planning a vacation?

Whether you are traveling within Colorado or across the US to your dream destination, USAFA ITT can help arrange your lodging!

From the mountains to the beaches and anywhere in between we've got you covered.

Let us book your summer vacation or Disney Cruise today by calling us at 719-333-7367.

IN-STATE TICKETS

(On-hand tickets available at ODR cashier)

iFly

2-Flight Voucher **\$67.99**

Family & Friends Pack **\$320**

(up to 5 people)

Boondocks

(Parker & Northglenn locations)

4-hours of play **\$32**

Overdrive Raceway

3-Race Ticket **\$49**

Denver Aquarium

Adult (12+) **\$17**, Child (3-11) **\$10.50**

Dinosaur Resource Center

Adult (13+) **\$12.50**, Child (5-12) **\$8.50**

US Olympic & Paralympic Museum

Adult (13+) **\$16.95**, Child (3-12) **\$11.95**

Elitch Gardens *(Call for pricing)*

1-Day Pass (buy 3, get 1 free)

Season Pass

Parking Pass

Meal Deal

Armed Forces Appreciation Days

(buy one get one)

Military Appreciation Week

(combo deal admission ticket and meal voucher)



ADDITIONAL IN-STATE TICKETS

(Pre-order tickets must be purchase though ITT)

Royal Gorge Railroad

Coach Adult (13+) **\$83** | Child (2-12) **\$76**

Deluxe Adult (13+) **\$110** | Child (2-12) **\$105**

Vista Dome Adult (13+) **\$110** | Child (2-12) **\$105**

The Edge Ziplines and Adventures

Epic Sky Trek starting at **\$48** (4 treks available)

Zipline Tours starting at **\$85** (10 tours available)

Ticket pricing subject to change without notice. Additional discounted tickets are available for other out-of-state attractions! Call ITT at 719-333-7367 for information and pricing. Blackout dates may apply. All ticket sales final.

COLORADO EVENTS

JUNE

June 2-21 (Fri-Sun)

Colorado College Summer Music Festival

June 7-9

Colorado Medieval Festival in Loveland

June 13-16

FIBArk Salida

June, 14-16

Scandinavian Midsummer Festival

June 15-16

Juneteenth Music Festival

June 15-16, 22-23, 29-30

Colorado Renaissance Festival

June 20-22

Country Jam

All dates subject to change.



OUT-OF-STATE TICKETS

2024 Disney World Salute Tickets

4-Day Park Hopper **\$369**

4-Day Park Hopper Plus **\$399**

5-Day Park Hopper **\$389**

5-Day Park Hopper Plus **\$419**

6-Day Park Hopper **\$409**

6-Day Park Hopper Plus **\$439**

Valid through 12/20/24. Eligibility restrictions apply. Blackout dates may apply.

2024 Disneyland Salute Tickets

3-Day Park Hopper **\$264**

3-Day Park Hopper Genie+ **\$352**

4-Day Park Hopper **\$309**

4-Day Park Hopper Genie+ **\$427**

Valid through 12/13/24. Eligibility restrictions apply. Blackout dates may apply.

2024 Universal Orlando Freedom Passes

2-Park *Park-to-Park* Adult (10+) **\$210**

Child (3-9) **\$205**

3-Park *Park-to-Park* Adult (10+) **\$245**

Child (3-9) **\$240**



Are you in need of a rental car?



CHOOSE ENTERPRISE OR HERTZ,
BOTH OFFER EXCELLENT BENEFITS!



Book now!

GREAT PRICES
JUST FOR
you!

United States Air Force Academy
Rocky Mountain
BLUE
AT KEYSTONE RESORT

SUMMER FUN...

VACATION AT  **KEYSTONE** THROUGH
ROCKY MOUNTAIN BLUE

THE ROCKY MOUNTAIN BLUE AIR FORCE partnership with Keystone Resorts in Colorado offers the military the best in lodging, recreation, conferences and reunions. RMB WELCOMES personnel from Air Force, Army, Navy, Marines, Coast Guard, Reserves, National Guard, DoD employees, retired military, immediate family members and their guests.

CALL TOLL FREE 866.768.2583

Visit usafasupport.com/rocky-mountain-blue/

or call

FOR RESERVATIONS



SCAN THIS



**DESTINATION:
GOOD TIMES**

**CLAIM EXCLUSIVE
ACTIVE DUTY MILITARY
PRICING RIGHT HERE**

24/25 ACTIVE DUTY MILITARY PRICING

IKON PASS	IKON BASE PASS
<p>\$799 USD (REGULAR PRICE \$1,249)</p>	<p>\$519 USD (REGULAR PRICE \$869)</p>



- Bring your DoD ID-card to the cashier counter to receive your Ikon discount code. One code per DoD ID-card holder ages 13 and up; passes for under 13 must be purchased on the same transaction as the sponsor.
- Redeem the code on the Ikon website.
- Active duty, retired, 100% disabled with DoD ID card only. No VHIC, DoD civilians, contractors. ID card must be shown to receive a code.